

REV.	DESCRIPTION	ECN	DATE	BY
A	NEW DRAWING	C-5621	07/28/2008	TLK
B	REPLACE WC PART NO. WITH VENDOR PART NO.	7050	5/26/2009	EFR
C	ITEM #2 WAS 14X27	7189	9/22/2009	EFR

REPAIR KIT SRK803				TIEROD ARM REPAIR KIT
ITEM	VENDOR / WC PART NO.	OLD PART NO.	QTY	DESCRIPTION
1	CHART	CHART	1	TIEROD ARM STEARING
2	1227Z1716	18080-017	1	NUT
3	K2616	18080-018	1	COTTER PIN
4	16X202	18080-023	1	KEY STEERING ARM

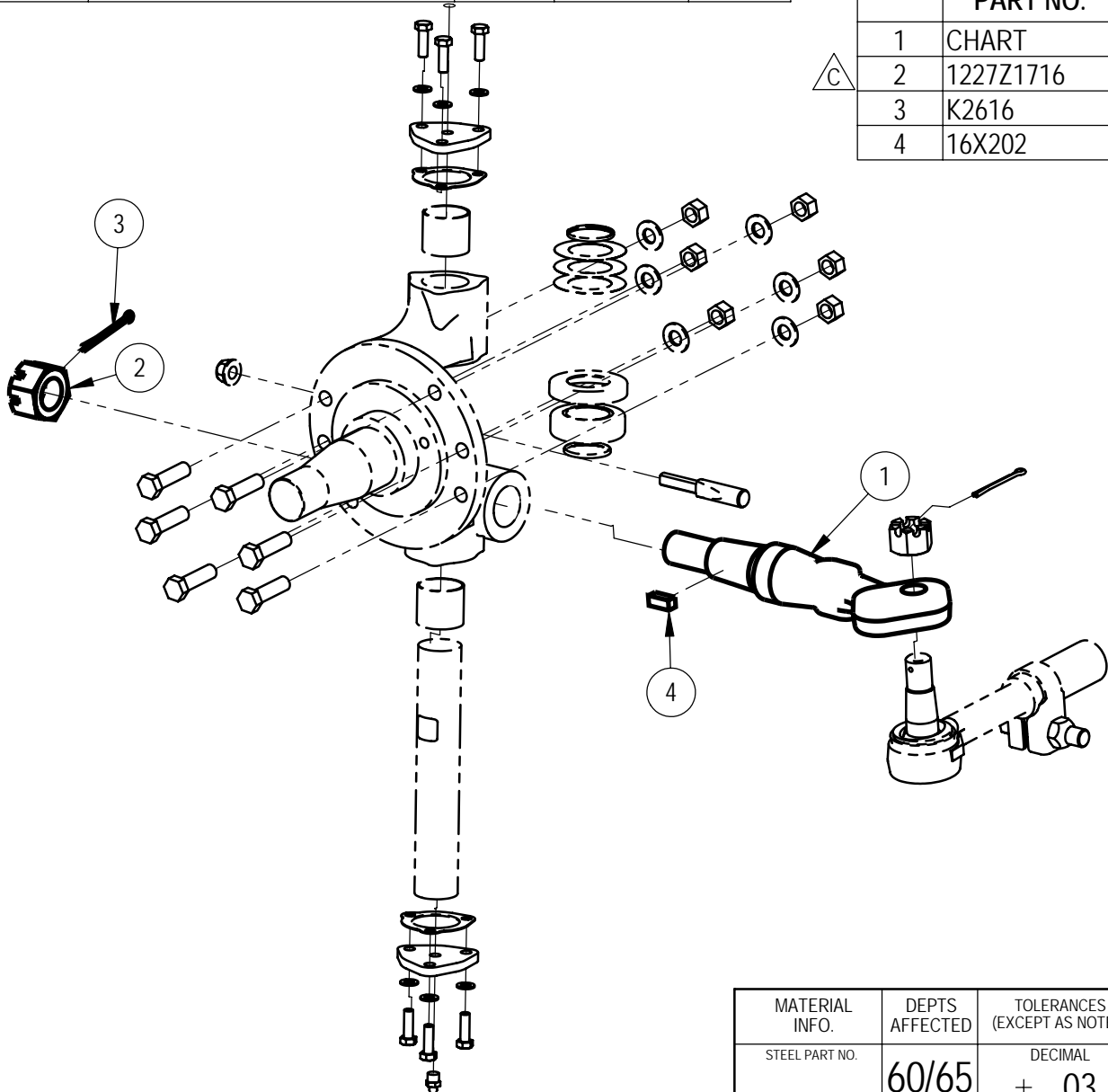

REPAIR KIT	LH/RH	ITEM #1 VENDOR NO.	ITEM #1 OLD NO.
SRK803-10	L.H.	X31333475	18080-015
SRK803-20	R.H.	X31333476	18080-016

MATERIAL INFO:	DEPTS AFFECTED:	TOLERANCES (EXCEPT AS NOTED):	DESCRIPTION: TIEROD ARM REPAIR KIT (MERITOR)	
STEEL PART NO:	60/65	DECIMAL ± .03	PREVIOUS ASSY:	-
MATERIAL:	-	FRACTIONAL ± 1/32	SUSPENSION MODEL:	SL08XX
WEIGHT:	-	ANGULAR ± 0.5°	SCALE:	1:6
			DATE:	07/28/2008
			DRAWN BY:	TLK
			SIZE:	A
			DRAWING NO:	SRK803

